

DISCOUNT LEVEL B

Model	LED colours	€
Lyra round		
Lyra R/B	Cool white	-----
Lyra R/WW	Warm white	-----
Lyra R/Z	Blue	-----
Lyra R/V	Green	-----
Lyra R/A	Ambar	-----
Lyra R/R	Red	-----
Lyra square		
Lyra C/B	Cool white	-----
Lyra C/WW	Warm white	-----
Lyra C/Z	Blue	-----
Lyra C/V	Green	-----
Lyra C/A	Ambar	-----
Lyra C/R	Red	-----

Finishes ■ Accessories

■ Finishes

Finish of	Description	Marking	Incr. €
Colour	St. Steel	(INOX)	-----
	Graphite	(GRF)	-----
	Matt chrome	(CHR-M)	-----
	Bright chrome	(CHR-B)	-----
	Nickel	(NI)	-----
	Gold	(AU)	-----
	Diffuser	Opal	(OPAL)
Transparent		(TR)	-----
Opal customised		(OPAL-P)	-----
Power supply	220-230V, 50/60Hz	(230V)	-----
	24V AC/DC (I = 0.01A)	(24V)	-----

■ Accessories

Product reference	Description	€
KE Lyra	Lyra recessed mounting box	-----
KPC Lyra	Positioner for installing the recessed mounting box on surfaces such as marble, wood, tile, formwork and concrete.	-----

DISCOUNT LEVEL C

Product reference	Description	Beacons supplied with power Lyra	€
Power units:			
PBL-24-02	Power unit with maintained output at 24 V DC, 0.2 A. Fitted with Ni-Mh battery. Provides 1 hour of duration.	20	-----
PBL-24-06	Power unit with maintained output at 24 V DC, 0.6 A. Fitted with Ni-Mh battery. Provides 1 hour of duration.	70	-----
PBL-25	Power unit with maintained output at 24 V AC/DC, 0.38 A. Fitted with Ni-Cd battery. Provides 1 hour of duration.	50	-----
PBL-80	Power unit with maintained output at 24 V AC/DC, 1.2 A. Power 220V AC/50Hz. Fitted with Ni-Cd battery. Provides 1 hour of duration. When mains power is available it has two power levels available, one being adjustable. Self-test mode operation.	130	-----
PBL-80 (Ni-Mh)	Power unit with maintained output at 24 V AC/DC, 1.2 A. Power 220V AC/50Hz. Fitted with Ni-Mh battery. Provides 1 hour of duration. When mains power is available it has two power levels available, one being adjustable. Self-test mode operation.	130	-----
PBL-24-02 TCA	Power unit with maintained output at 24 V DC, 0.2 A. Fitted with Ni-Mh battery. Provides 1 hour of duration. Includes microprocessor for operation with DaisaTest central system	20	-----
PBL-24-06 TCA	Power unit with maintained output at 24 V DC, 0.6 A. Fitted with Ni-Mh battery. Provides 1 hour of duration. Includes microprocessor for operation with DaisaTest central system	70	-----
TL-40	Transformer 230 V AC/24V AC.	80	-----
DIR-1	Directional coupler switch at 24 V AC/DC enabling one of four beacons to light up sequentially to indicate a direction. Maximum 25 Lyra beacons per output.	100	-----

Note: Technical data and dimensions of these power units on page 102.

Operation, shared data and notes:

The Lyra beacon comes with a recessed mounting box (as standard).

Built to the EN 60598-2-22 (IEC 60598-2-22) standard. Protection rating: **IP62 IK07**.

Lyra

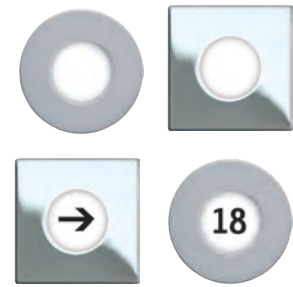

Option of opaline or customised diffuser (black) on request.

Installation of box with KPC Lyra positioner

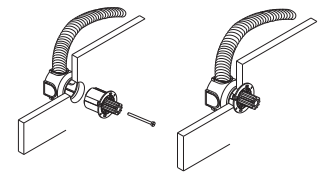

Mounting with housing

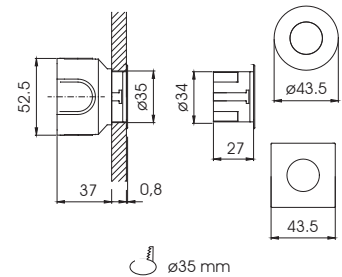

Mounting without housing

